

You'll not find any remaining Meander Posts that would be remotely relevant to Presque Isle. The original surveys were done in 1862 and even the section makers were only done with wooden posts. All of these would have been subsequently replaced with steel rods, pipes and plastic posts by now. The other marking that were routinely used were a blaze on a tree. Considering that any tree of appropriate size in 1862 would have been a big tree by the time logging (and photographers) came to these parts, probably original tree blazes have all been logged.

## A County S&O Survey using Meander Posts

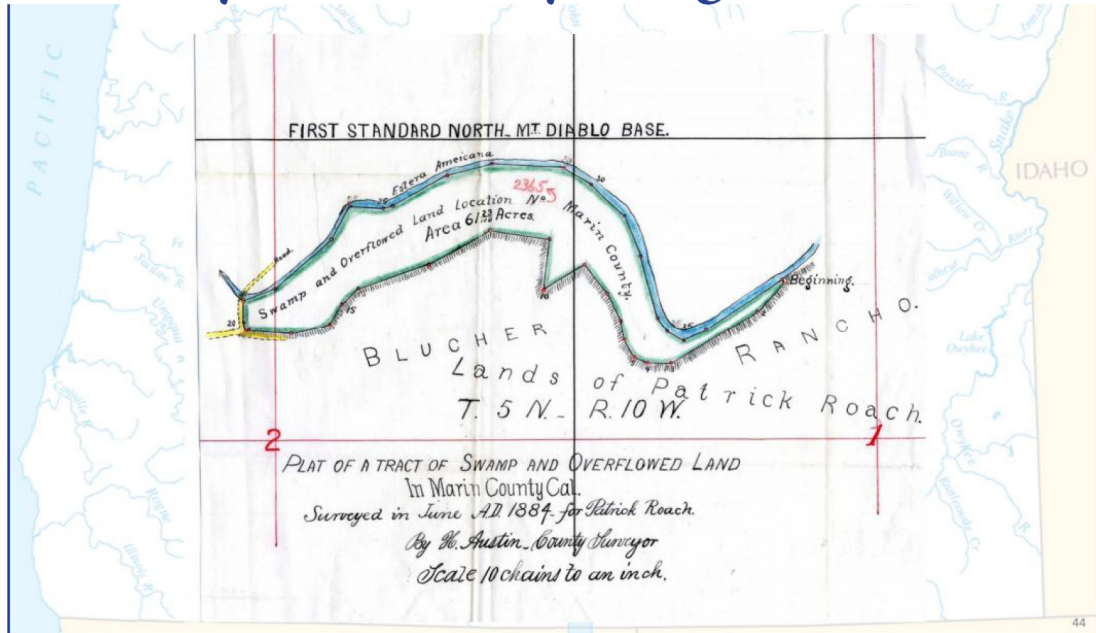

An irregular surveyed line following the outline of a body of water that is used to measure abutting property which is not a legal boundary line is referred to as a Meander Line.